

**Only**

**FONTAINE®**

**Gives You the No-Slack® Advantage**

# Instructions



- Installation Instructions
- Pre-Service Procedures
- Operating Instructions
- Inspection & Maintenance Procedures
- Warranty

**FOR YOUR SAFETY USE ONLY GENUINE FONTAINE SERVICE PARTS. USING PARTS THAT DO NOT MEET FONTAINE SPECIFICATIONS WILL VOID WARRANTY.**

Read before mounting or operating fifth wheel.

After fifth wheel is installed these important instructions must be permanently retained in the tractor glove box.

**WARNING:** Failure to follow these instructions could cause a hazardous operating condition.



# Fontaine® Fifth Wheel Handbook

---

For over 60 years, Fontaine has been passing customer performance tests by building fifth wheels with innovative technology, uncompromising quality, and features designed to ensure cost-efficient performance.

This handbook provides instructions and recommended procedures for optimum performance from your new fifth wheel. Included are: Installation Instructions, Pre-Service Procedures, Operating Instructions, Inspection and Maintenance Procedures. **Keep this handbook in the tractor glove box after your fifth wheel has been installed.**

If you have any questions concerning your new fifth wheel, our Customer Service Group is available to help you. (800) 874-9780.

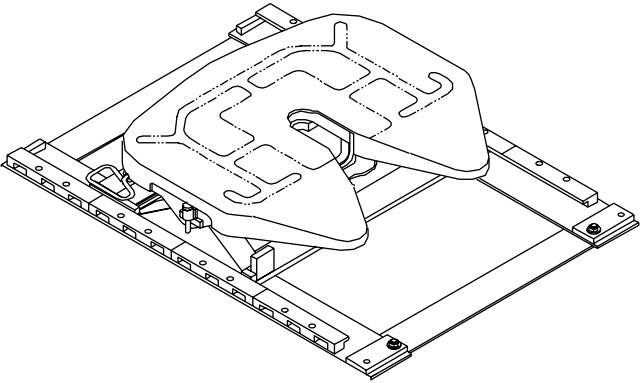

For sales and service locations or for additional copies of this handbook go to our web site at [www.fifthwheel.com](http://www.fifthwheel.com).

<b>Section I – Installation Instructions</b>	
General Mounting Instructions.....	4-5
Application/Restriction Levels.....	6
Air Wedge Slide Bracket Fifth Wheel (ATB) and Manual Wedge Slide Bracket Fifth Wheel (MTB).....	7
Air Wedge Slide Bracket Fifth Wheel (AWB) and Manual Wedge Slide Bracket Fifth Wheel (MWS).....	8
Stationary Fifth Wheel with Long Mounting Plate (PLA).....	9
Stationary Fifth Wheel with Short Mounting Plate (PSA).....	10
Adjustable Flat Plate Mount Fifth Wheel (PMA).....	11
Stationary Frame Mount Fifth Wheel (FMA).....	12
Stationary 36" Angle Mount Fifth Wheel (A36).....	13
Xtra Heavy Duty Air Wedge Slide Bracket Fifth Wheel (XAWX).....	14
Xtra Heavy Duty Short Plate Mount Fifth Wheel (XPSA).....	15
Xtra Heavy Duty Long Plate Mount Fifth Wheel (XPLA).....	16
<b>Section II – Pre-Service Procedures</b>	
Fasteners.....	17
Lubrication.....	18-19
Operation.....	19-22
Wedge Stop Rod Setting.....	23
Knock-Out Rod.....	24
<b>Section III – Operating Instructions.....</b>	<b>25-31</b>
<b>Section IV – Inspection and Maintenance     Procedures.....</b>	<b>32-35</b>
<b>Section V – No-Slack® Limited Warranty.....</b>	<b>36-38</b>

# Section I – Installation Instructions

## General Mounting Instructions

1. **Do not** modify and/or customize any fifth wheel or mounting assembly. Modifying or welding to the product will void product warranty. Only Fontaine authorized procedures, such as welding the stop blocks or the rocker limiting blocks are acceptable. Welding must be performed by a certified welder.
2. The fifth wheel should be installed with the pivot point of the fifth wheel located on or ahead of the rear axle or bogie center line. The installation shall be in accordance with DOT regulations, state and local ordinances, SAE and TMC practices and standards, and tractor manufacturers' recommendations.
3. All fifth wheels shall be located so that the tractor and trailer will maintain clearance at all times. On sliding fifth wheels, it may be necessary to "block out" forward locations.
4. All mounting fasteners must be a minimum of:
  - 5/8" diameter - Grade 8 bolts
  - 5/8" diameter - Grade C lock nuts
  - 5/8" diameter - Hardened flat washers
5. Outboard mounting angles shall be ASTM-A36 or equal with a minimum thickness of 5/16".
6. Inboard mounting angles must have a 4" minimum vertical and horizontal leg and shall be not less than 36" long.
7. Outboard mounting angles must have a minimum horizontal leg of 3" and vertical leg of 3-1/2".
8. The full length, horizontal flange of the outboard mounting angles must be at the **same elevation** as the truck frame. The vertical leg of the angle must fit **flush** with the truck frame. To accomplish this, firmly clamp the fifth wheel and angle in position before drilling the tractor frame. **Warning: Failure to follow these specifications will void warranty and could affect product performance.**

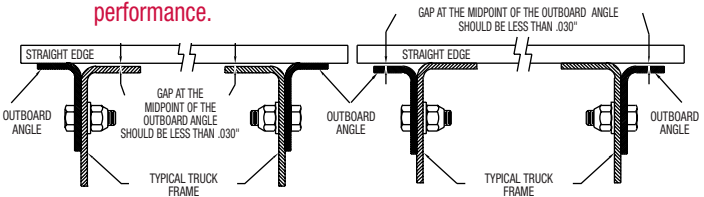

9. All mounting holes in the truck frame or mounting angles shall be drilled, not burned. All edges and corners shall be ground smooth to prevent point loading (see illustrations next page).

## Installation Instructions

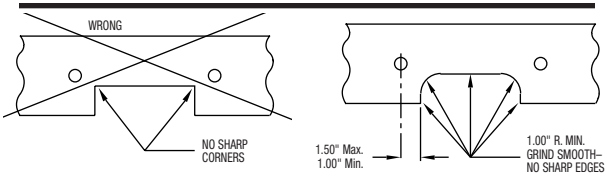

- When required to clear obstructions (such as spring hangers) cut-outs shall be smooth and straight with a minimum radius of 1". No sharp corners are permitted and all edges shall be ground smooth. A minimum of two bolts is recommended beyond a cut-out.
- Care must be taken to avoid interference or contact between the fifth wheel and air brake modulator when rear of fifth wheel is depressed. In order to prevent this, it is recommended that a stop be attached to the underside of the rear extension of the fifth wheel. The stop should be positioned so that contact is made with the fifth wheel mounting plate.
- Do not restrict normal rock of fifth wheel. This could create a hazardous operating condition.
- All fifth wheels subjected to weather abuse must be thoroughly cleaned, inspected, and lubricated prior to installation.
- Refer to the Application/Restriction Level guide (page 6) when selecting a fifth wheel for an appropriate application.

- Fifth Wheels with sliding or fixed mounts should be mounted in the proper orientation relative to the tractor (See Figure 1).

**Do not** mount the fifth wheel upside down or backwards.

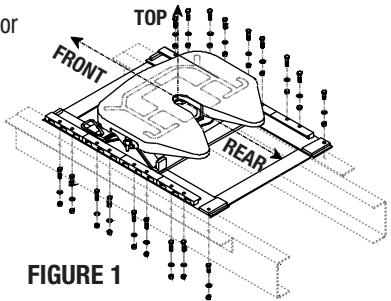

FIGURE 1

- The trailer that is attached to the fifth wheel should impose a consistent vertical load. Repeated negative loading (trying to pull the fifth wheel off of the brackets with the king pin) is not allowed. A **minimum** vertical static load applied to the fifth wheel through the trailer is 10% of the gross trailer weight. See the load rating for the specific fifth wheel for maximum vertical load values.
- Do not** center load the fifth wheel. The vertical load should be distributed over the entire surface of the fifth wheel.
- Fixed angle mounts (inboard angles) shall be flush with the top of the truck frame. (No gap between the truck frame and the angle).
- Do not** attempt to "block" 6000 series fifth wheel. A production "blocked" fifth wheel specifically designed for this application is available

# Fontaine® Fifth Wheel Handbook

---

## APPLICATION/RESTRICTION LEVELS

**STANDARD DUTY:** 6000, 7000, H5092 top plate models depending on application, rated vertical capacity and GCW. Fifth Wheel must be used in a 100% on-highway application, with more than 30 miles between each stop. The total number of towed axles equals 2. Road type must be maintained concrete or asphalt. Gross Combination Weight (GCW) is less than 95,000 pounds or 43,000 kilograms.\*

**MODERATE DUTY:** 6000, 7000, H5092 & X5092 top plate models depending on application, rated vertical capacity and GCW. Fifth Wheel must be used in a less than 10% off-highway application, with no minimum mileage between each stop. The maximum total number of towed axles equals 4. Road type must be maintained concrete, asphalt, gravel, or crushed rock. Gross Combination Weight (GCW) is less than 115,000 pounds or 52,000 kilograms.\*

**SEVERE DUTY:** 7000, H5092 & X5092 top plate models depending on application, rated vertical capacity and GCW. Fifth Wheel can be used in any off-highway application, with no minimum mileage between each stop. The total number of towed axles equals 5 or more. All road types are acceptable including hard packed dirt and non-maintained roads. Gross Combination Weight (GCW) is more than 115,000 pounds or 52,000 kilograms.\*

**\* NOTE: See Fontaine Application Guide LT-076 for specific application recommendations. Product used in unapproved applications voids manufacturer warranty.**

### Important Application Notes:

1. If any single restriction factor within your application is surpassed within a given duty level, the next duty level must be selected.
2. When selecting a fifth wheel, if the application or vehicle usage places the maximum capacity on a certain fifth wheel, then the selection of a fifth wheel with a higher capacity is advised. For example, a tractor that is at a maximum vertical load of 50,000 lbs. in a moderate duty application should be using a fifth wheel with a vertical load capacity of 55,000 lbs. or greater. This additional capacity should give better service life over a longer period of time.
3. All logging applications are considered severe duty. Do not select fifth wheels in the standard or moderate levels when a logging application is designated.

# Installation Instructions

## Air Wedge Slide Bracket Fifth Wheel (ATB) & Manual Wedge Slide Bracket Fifth Wheel (MTB) -- ATB Shown

Adjustment of 24" shown. Greater adjustment requires longer angle and additional mounting bolts. See suggested price list for angle sizes and lengths available. The full length of the horizontal flange of the outboard mounting angles must be at the **same elevation** as the truck frame. The vertical leg of the angle must fit **flush** with the truck frame.

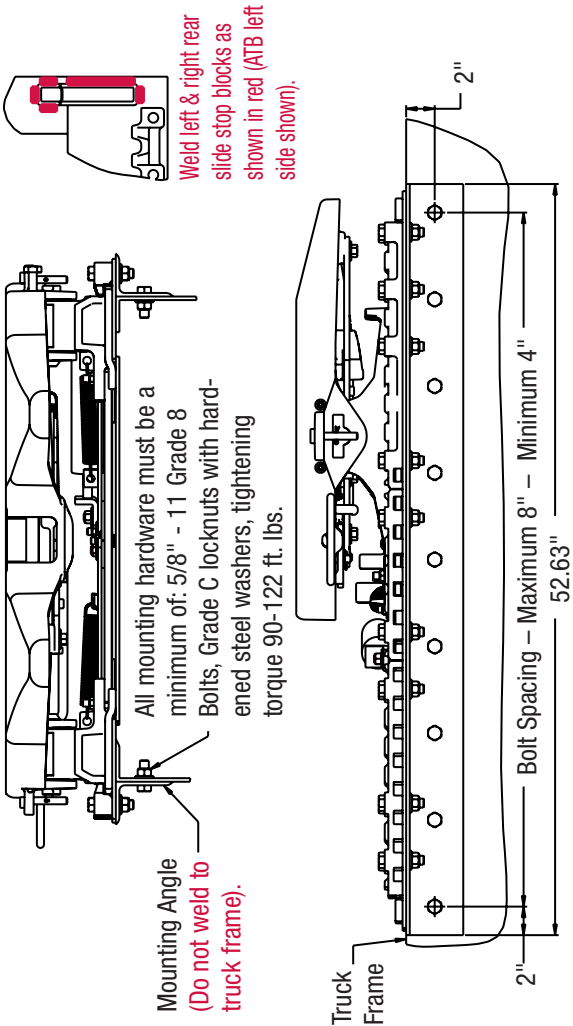

# Fontaine® Fifth Wheel Handbook

## Air Wedge Slide Bracket Fifth Wheel (AWB) & Manual Wedge Slide Bracket Fifth Wheel (MWS) -- AWB Shown

Adjustment of 24" shown. Greater adjustment requires longer angle and additional mounting bolts. See suggested price list for angle sizes and lengths available. The full length of the horizontal flange of the outboard mounting angles must be at the **same elevation** as the truck frame. The vertical leg of the angle must fit **flush** with the truck frame.

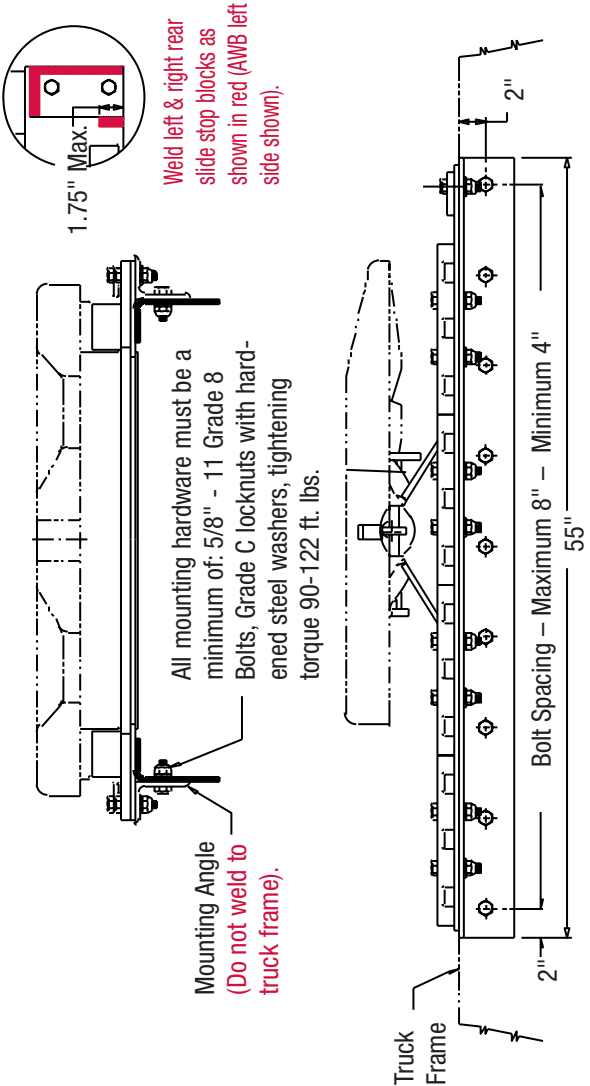

# Installation Instructions

## Stationary Fifth Wheel with Long Mounting Plate (PLA)

The full length of the horizontal flange of the outboard mounting angles must be at the **same elevation** as the truck frame. The vertical leg of the angle must fit **flush** with the truck frame.

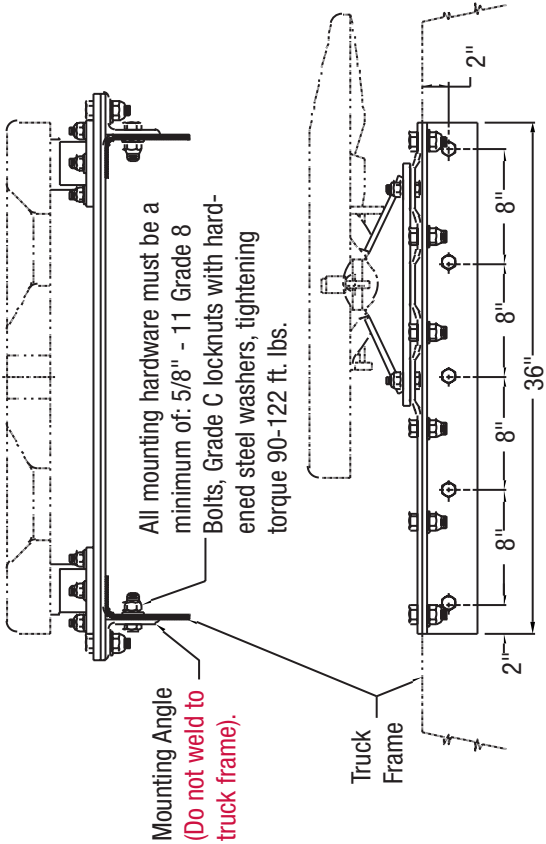

# Fontaine® Fifth Wheel Handbook

## Stationary Fifth Wheel with Short Mounting Plate (PSA)

The full length of the horizontal flange of the outboard mounting angles must be at the **same elevation** as the truck frame. The vertical leg of the angle must fit **flush** with the truck frame.

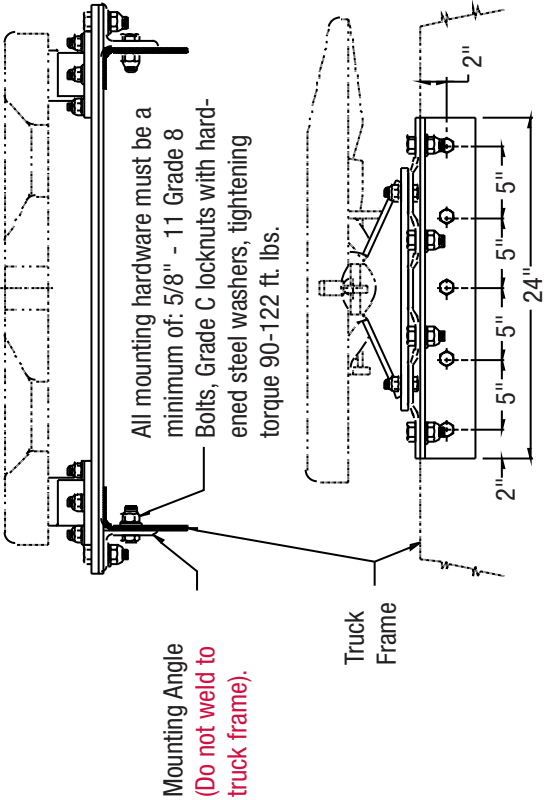

# Installation Instructions

## Adjustable Flat Plate Mount Fifth Wheel (PMA)

Adjustment of 18" shown. Greater adjustment requires longer angles and additional mounting bolts. See suggested price list for angle sizes and lengths available. The full length of the horizontal flange of the outboard mounting angles must be at the **same elevation** as the truck frame. The vertical leg of the angle must fit **flush** with the truck frame.

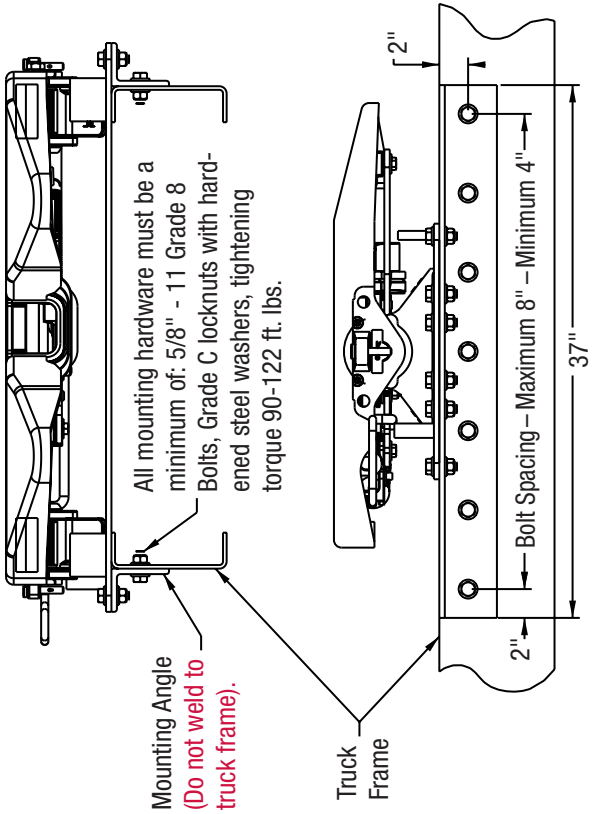

# Fontaine® Fifth Wheel Handbook

## Stationary Frame Mount Fifth Wheel (FMA)

The full length of the horizontal flange of the outboard mounting angles must be at the **same elevation** as the truck frame. The vertical leg of the angle must fit **flush** with the truck frame. The full length of the vertical and horizontal legs of the inboard angles must be **flush** with the inside of the truck frame.

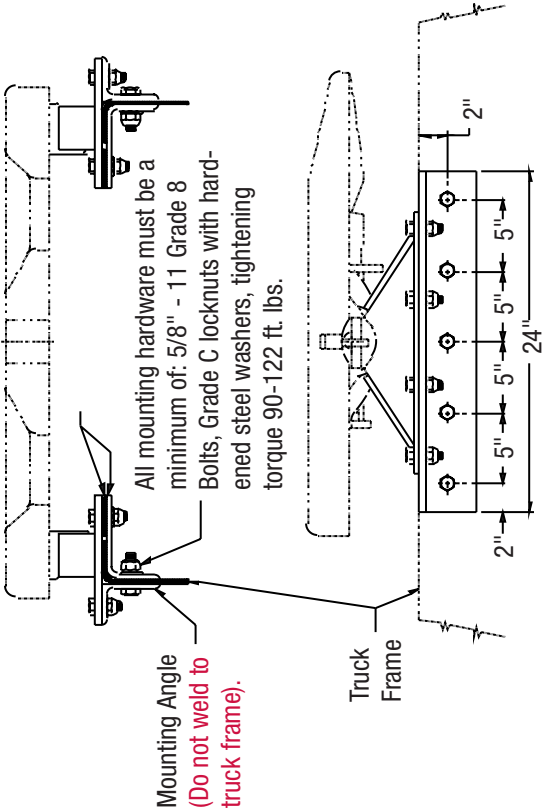

# Installation Instructions

## Stationary 36" Angle Mount Fifth Wheel (A36)

The full length of the horizontal and vertical legs of the angles must fit **flush** with the truck frame.

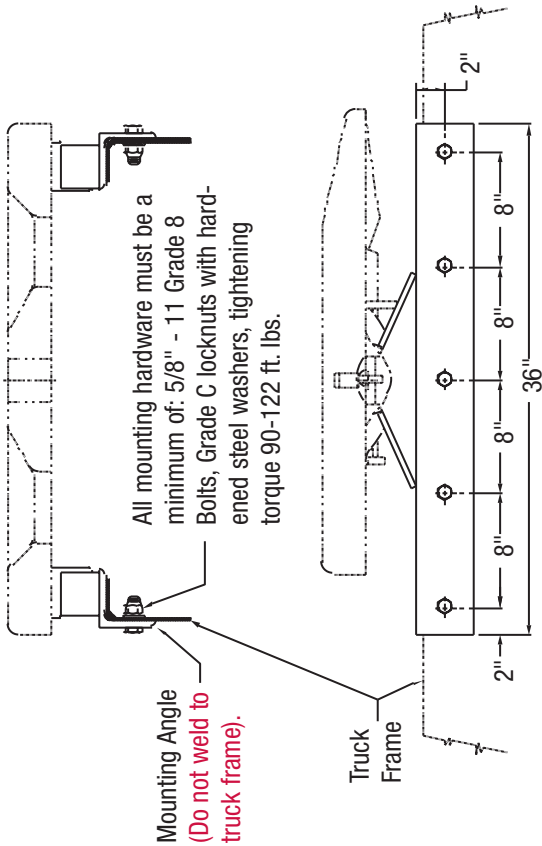

# Fontaine® Fifth Wheel Handbook

## Xtra Heavy Duty Air Wedge Slide Bracket Fifth Wheel (XAWX)

Adjustment of 24" shown. Greater adjustment requires longer angle and additional mounting bolts. See suggested price list for angle sizes and lengths available. The full length of the horizontal flange of the outboard mounting angles must be at the **same elevation** as the truck frame. The vertical leg of the angle must fit **flush** with the truck frame.

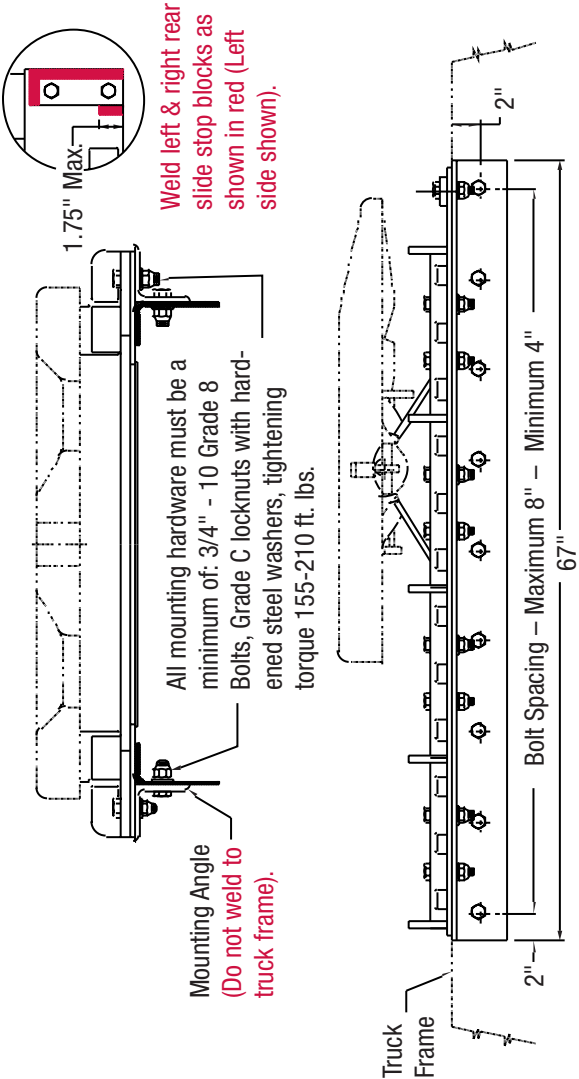

## Installation Instructions

### Xtra Heavy Duty Short Plate Mount Fifth Wheel (XPSA)

The full length of the horizontal flange of the outboard mounting angles must be at the **same elevation** as the truck frame. The vertical leg of the angle must fit **flush** with the truck frame.

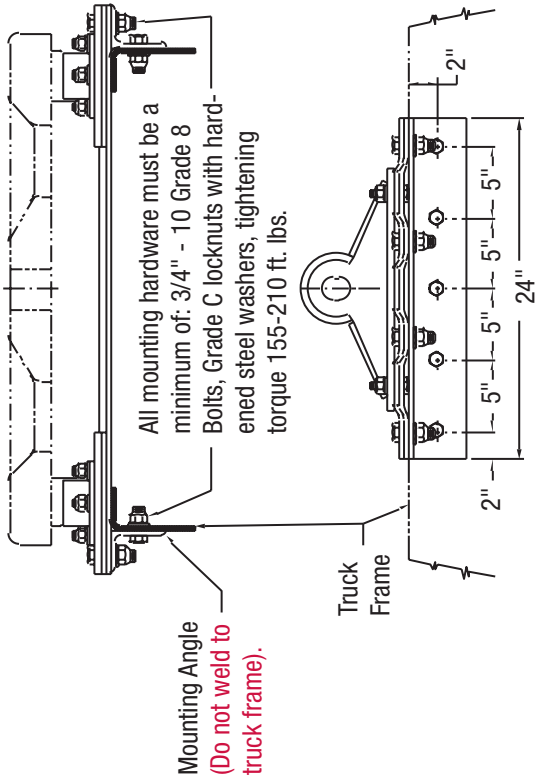

# Fontaine® Fifth Wheel Handbook

## Xtra Heavy Duty Long Plate Mount Fifth Wheel (XPLA)

The full length of the horizontal flange of the outboard mounting angles must be at the **same elevation** as the truck frame. The vertical leg of the angle must fit **flush** with the truck frame.

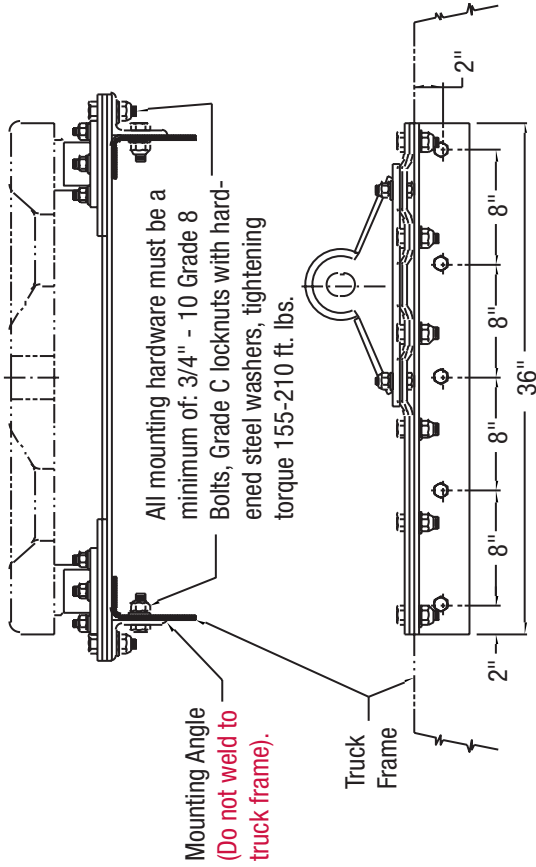

## Section II – Pre-Service Procedures

Always check for damage due to improper handling or delivery practices prior to starting recommended pre-service procedure

### A. Fasteners

Make sure all nuts and bolts are in place and properly tightened.

Check to see if both bracket pins are in place and secured by retainer pins and cotter pins (Figure 1).

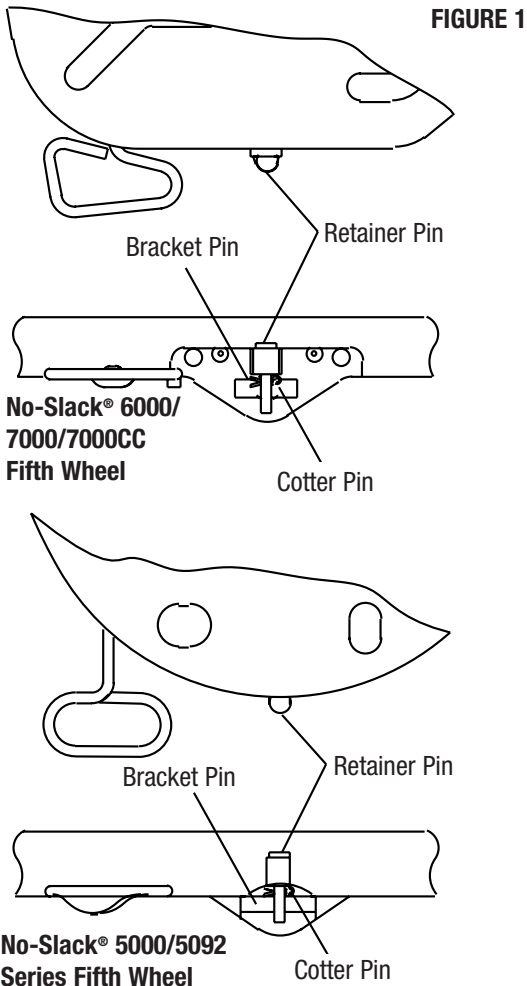

## B. Lubrication

1. Tilt the top plate forward (front of the fifth wheel down) and apply grease to each bearing area through the zerk fitting (No-Slack® 6000/7000/7000CC has two fittings each side) located on each side of the top plate just to the front of the bracket pins. Continue to apply grease until it is coming out of the back of the bearing. It may be necessary to raise the rear of the fifth wheel with a pry bar to open up the pocket slightly and allow the grease to flow through. A substantial amount of grease may be required initially to fill the reservoir. Tilt the wheel to the rear (rear of the wheel down) and repeat the procedure. Rock the top plate back and forth several times to spread the grease over the bearing surface.

Inspect the trailer kingpin plate and top surface of the fifth wheel to make sure each is properly greased. A liberal coating of grease should be applied to the complete surfaces of both the trailer kingpin plate and the top surface of the fifth wheel. A paddle or brush will make this job easier.

**Do not use a lube plate (high density polyethylene) on top of the fifth wheel or on the kingpin in lieu of grease without prior approval by Fontaine Fifth Wheel.** The additional thickness of this material can prevent the proper operation of the fifth wheel and can cause a dangerous condition.

2. Lubricate the fifth wheel prior to opening and closing. Referring to Figures 2-5 (on next page), grease the jaw and wedge on top and bottom. Separate the jaw and wedge with a large screwdriver and distribute the grease along the full length of the jaw and wedge mating surfaces. Open and close the fifth wheel several times to further distribute the grease.

Fontaine suggests the use of a Moly based lubricant such as Mobilgrease XHP320 or equivalent when applying lubricant to the locking jaw and wedge.

## Pre-Service Procedures

Lightly oil other moving parts in the fifth wheel. (Areas or regions that experience extreme and/or prolonged freezing temperatures should consider using a less viscous substance such as: 90-weight oil, diesel fuel, kerosene, motor oil, etc. Fontaine suggests contacting your specific lubricant manufacturer for guidelines on mixing compatibility of any lubricant).

3. For sliding Fifth Wheels, lightly oil the locking mechanism. Operate the mechanism (air or manual) several times to ensure it is functioning properly.
4. Grease the top plate. Spread grease all over the mating surface of the top plate. Be sure the grease pockets built into the top plates are full of grease.

### C. Operation

1. Fontaine's No-Slack® 6000/7000/7000CC & Retractable Handle fifth wheels shown in Figure 2 & 3 open by a straight pull on the release handle which releases the secondary lock automatically as the mechanism opens.

**FIGURE 2 – NO-SLACK® 6000/7000/7000CC**

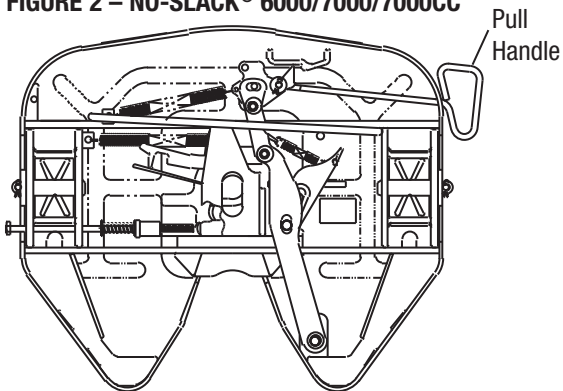

# Fontaine® Fifth Wheel Handbook

**FIGURE 3 – NO-SLACK® 6000/7000/7000CC**

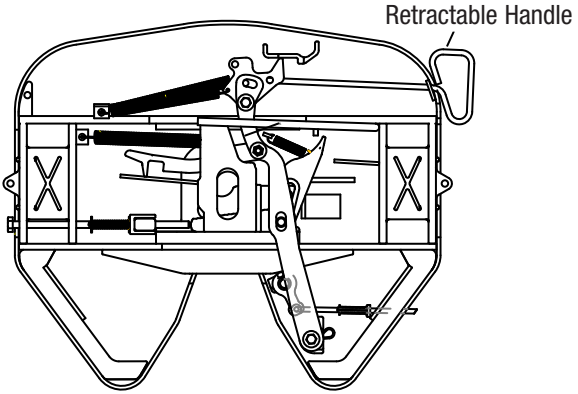

2. Fontaine No-Slack® 5092 series offers several types of pull handles. The Side Release Fifth Wheel is shown in Figure 4. To open, lift the pull handle and pull. A slight jerk on the handle makes the opening easier.

**FIGURE 4 – 5000/5092 SERIES**

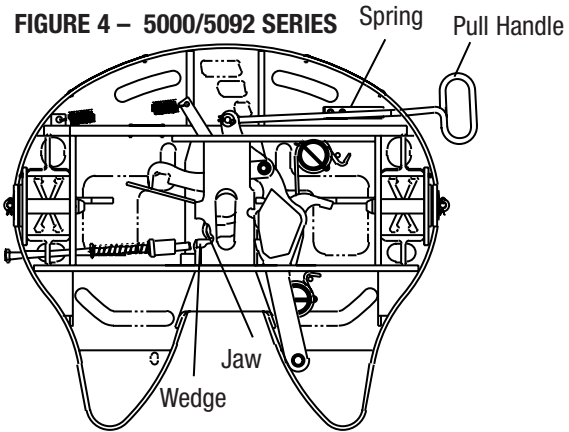

**FIGURE 5**

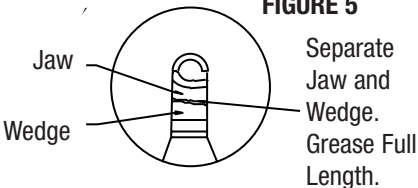

- Figure 6 shows a No-Slack® 5092 series Retractable Handle. To open, move the handle to the rear and pull.

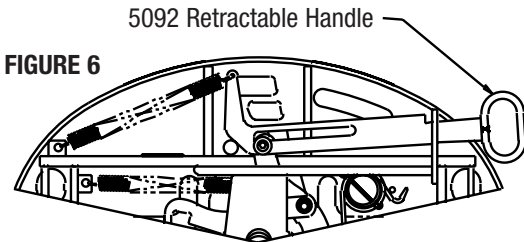

- Fontaine's air actuated No-Slack® 6000/7000/7000CC air-actuated fifth wheel is shown in Figure 7 and Fontaine's No-Slack® 5092 air-actuated fifth wheel is shown in Figure 8. They open with a release valve located on the dash or in a lock box mounted on the rear of the cab. To open, set the tractor parking brake and pull the release valve. Hold the valve open until the locking mechanism is locked in the open position. The pull valve will not activate the air cylinder unless the tractor parking brakes are set.

**FIGURE 7 – NO-SLACK® 6000/7000/7000CC**

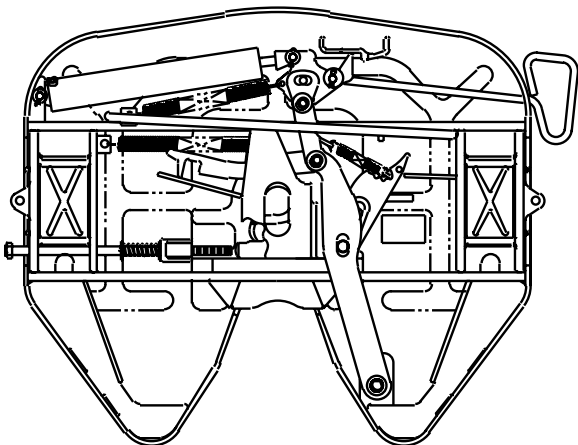

**FIGURE 8 – NO-SLACK® 65092 SERIES**

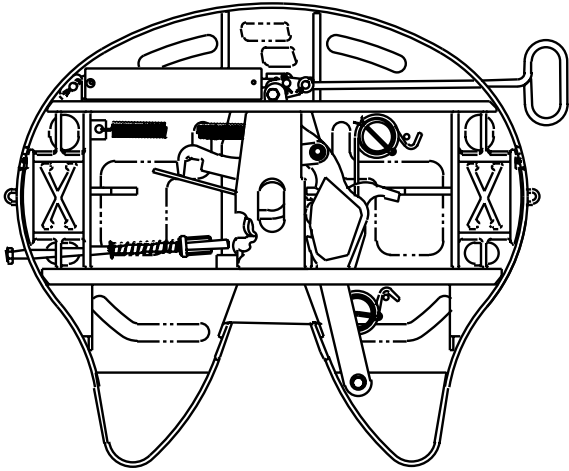

5. Close the locking mechanism using a test kingpin or 2" diameter pipe. Repeat several times making sure that all moving parts have adequate lubrication.
6. The pull handle should always be free of grease or any substance which could prevent a firm grip, causing the handle to slip and resulting in injury.

### D. Wedge Stop Rod Setting

Wedge stop rod adjustment is not required as part of the pre-service procedure. It is set during the final assembly inspection at our manufacturing facility. At the first recommended P.M. (90 days or 30,000 miles whichever comes first) and every 90 days or 30,000 miles there after, the wedge stop rod should be adjusted per technical Bulletin TB-012.

Note P.M. intervals are recommended based on standard duty applications. Applications more severe than standard duty may require different P.M. intervals to ensure peak performance.

**FIGURE 9 – NO-SLACK® 6000/7000/7000CC**

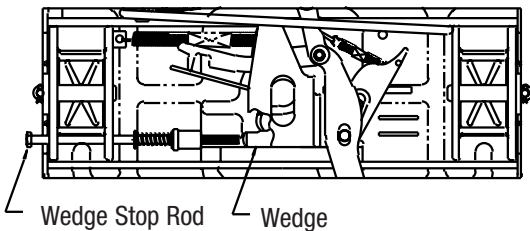

**FIGURE 10 – NO-SLACK® 5000/5092 SERIES**

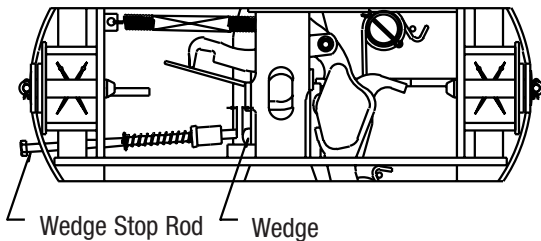

**This Wedge Stop Rod can also be used to release a tight wedge (hard to pull handle) by tapping the rod with a hammer to release the wedge.**

## E. Knock-Out Rod

The knock-out rod requires no adjustment (See Figure 11) and is used to release a tight wedge (hard to pull handle) by tapping the rod with a hammer.

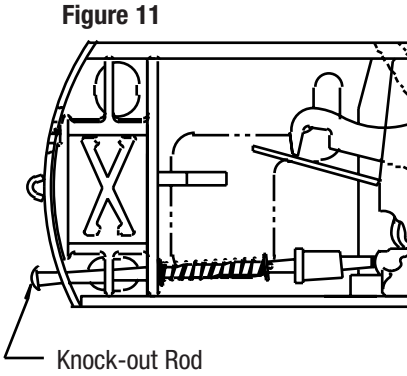

## Section III – Operating Instructions

### COUPLING PROCEDURE:

1. Prior to coupling, inspect the fifth wheel to ensure a proper operation.
  - Examine the mounting assembly for securely fastened bolts.
  - Tilt the fifth wheel up and down to make sure that it moves freely. Rest the fifth wheel in the proper position by tilting it to the rear of the tractor and resting it on the stops.
  - Check the surface for a liberal coating of grease. The indented pockets on top of the fifth wheel act as a grease reservoir for the top surface and should be filled with grease.
  - If the tractor is equipped with an air sliding fifth wheel, actuate the air cylinder and check for air leaks. **WARNING: AIR CYLINDER DISASSEMBLY SHOULD NOT BE ATTEMPTED.**
  - The fifth wheel should be in an unlocked position. When unlocked, the handle should be extended (see Figure 12) and the fifth wheel throat unobstructed (For the 5092 Series the ends of the jaw and wedge are visible). If the fifth wheel is equipped with a retractable handle, the handle will not be fully extended. **DO NOT TRY TO COUPLE TO A CLOSED FIFTH WHEEL.**

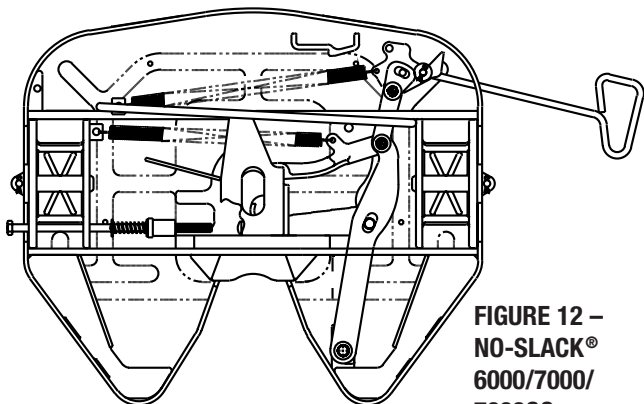

**FIGURE 12 –  
NO-SLACK®  
6000/7000/  
7000CC**

## Fontaine® Fifth Wheel Handbook

---

2. The trailer kingpin should also be inspected prior to coupling. The kingpin plate should be fully reinforced and of sufficient size to completely cover the fifth wheel. If the kingpin plate is too narrow, the uncovered portion of the fifth wheel will collect dirt and foreign matter. This material may work into the fifth wheel locking mechanism, causing wear and occasionally difficult uncoupling. This material can also cause galling of the fifth wheel and/or kingpin plate.

If the trailer kingpin plate is not fully reinforced, distortion can result causing:

- Non-uniform loading
- Variation in kingpin length
- Cutting and galling of the fifth wheel or kingpin plate

If the trailer kingpin plate is distorted enough to cause any of the conditions listed above, we recommend that a new plate be installed.

The trailer kingpin plate must be properly greased.

Fontaine Fifth Wheels are designed and manufactured for use with all trailer kingpins that conform to SAE specifications, SAE J700, February 1993 and subject to the wear limits of SAE J2228, June 1993. These specifications cover SAE 2" kingpins only.

The SAE standard kingpin can be checked using the dimensions given in Figure 13 (next page).

## Operating Instructions

**FIGURE 13 SAE STANDARD KING-PIN (SAE J700, FEB 93)**

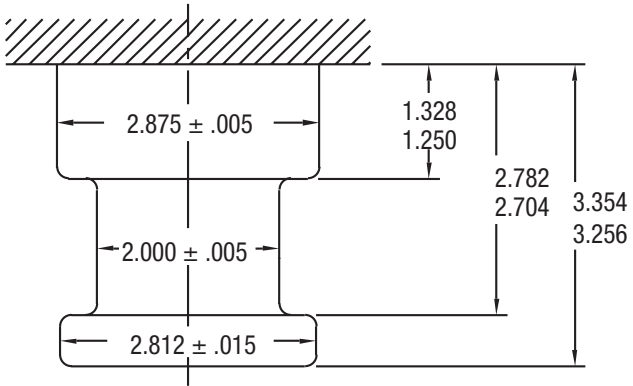

3. Proper tractor/trailer alignment is critical to obtain a secure coupling and to avoid equipment damage.

Set the trailer brakes and raise the trailer to the proper height by extending the landing legs. If the trailer is positioned too high, the kingpin may jump the fifth wheel throat and locking mechanism altogether. Resulting damage may include: scoring the fifth wheel, bending the handle thus preventing the fifth wheel from properly locking to the kingpin, bending the kingpin, and other significant damage to the tractor cab.

Coupling should not be attempted if the trailer is too low. Costly damage may be incurred to the trailer, the kingpin, the kingpin plate, the fifth wheel, and the entire tractor drivetrain.

4. To couple the fifth wheel to the kingpin, be sure the fifth wheel is positioned so that it tilts down at the rear and is resting on the stops.

Align the kingpin with the throat of the fifth wheel and ease the tractor toward the trailer. The trailer should strike the fifth wheel just at the top of the approach ramps. The fifth wheel will level with the kingpin plate and the kingpin should slide up the fifth wheel throat.

## Fontaine® Fifth Wheel Handbook

Coupling is complete when the fifth wheel locking mechanism snaps closed behind the kingpin.

Verify secure coupling with a "tug test," by easing the tractor forward, with trailer brakes on, to feel resistance of the load. If the coupling feels secure, visually inspect the fifth wheel. The jaw and wedge must be locked in place behind the kingpin, completely across the throat of the fifth wheel, and the pull handle must be retracted and securely latched in the secondary lock.

### HOW TO TELL IF THE FIFTH WHEEL IS LOCKED.

#### No-Slack® 6000/7000/7000CC Series (see Figure 14).

Verify secure coupling with a "tug test," by easing the tractor forward, with trailer brakes on, to feel resistance of the load. The locking jaw and wedge must be fully across the throat of the wheel. In addition, the pull handle must be within 1" of the skirt of the wheel. The pull handle should be used as a positive lock indicator.

#### Fifth Wheel Closed

#### FIGURE 14

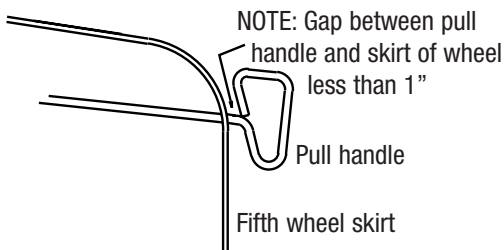

#### Fifth Wheel Not Closed

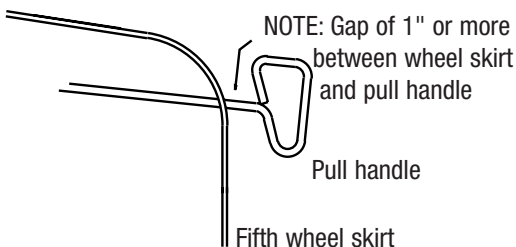

## Operating Instructions

### No-Slack® 6000/7000/7000CC Series Retractable Handle (see Figure 15).

Verify secure coupling with a "tug test," by easing the tractor forward, with trailer brakes on, to feel resistance of the load. The locking jaw and wedge must be fully across the throat of the wheel. The lock indicator should be visually exposed indicating the fifth wheel is closed.

**Fifth Wheel Closed**

**FIGURE 15**

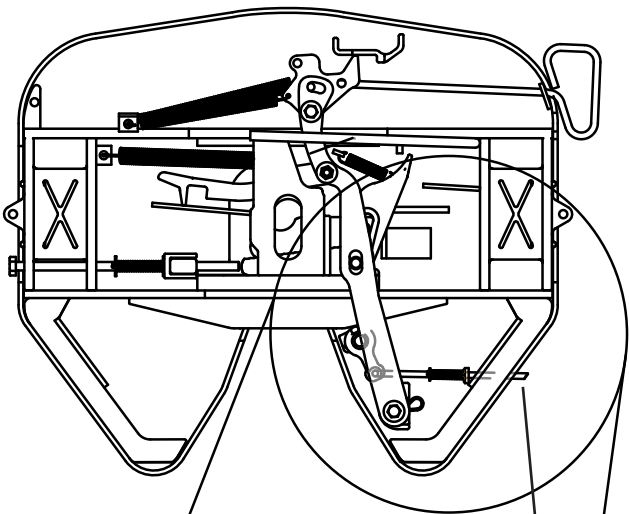

Note: Lock indicator is extended and exposed visually indicating the fifth wheel is locked.

**Fifth Wheel  
Not Closed**

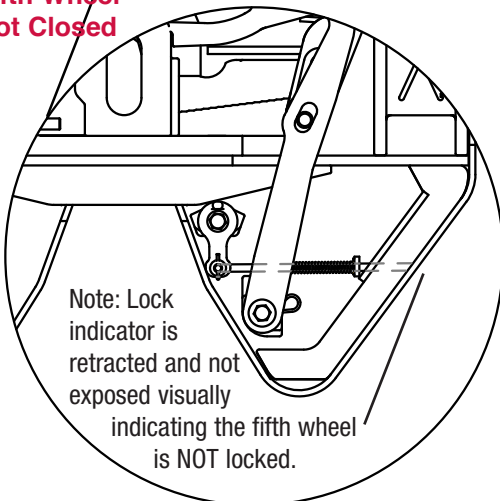

Note: Lock indicator is retracted and not exposed visually indicating the fifth wheel is NOT locked.

**No-Slack® 5092 Series (see Figure 16).**

Verify secure coupling with a "tug test," by easing the tractor forward, with trailer brakes on, to feel resistance of the load. The locking jaw and wedge must be fully across the throat of the wheel and the bottom section of the (2) piece pull handle should be in and down behind the triangular piece located just inside the fifth wheel skirt.

**Fifth Wheel Closed**

**FIGURE 16**

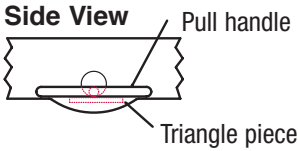
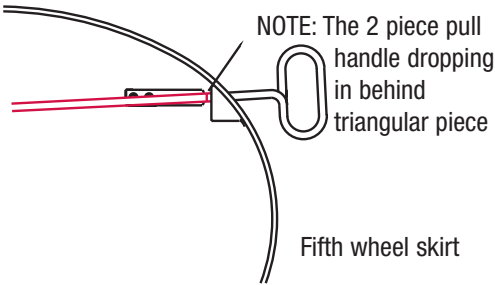

**Fifth Wheel Not Closed**

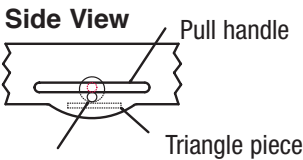
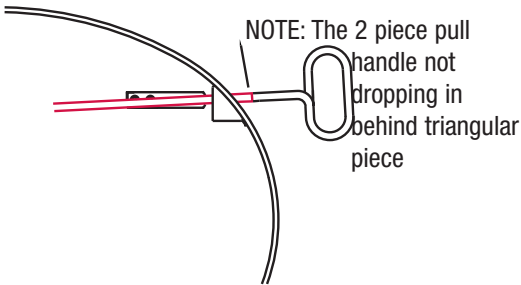

Note: Bar is visible

## Operating Instructions

---

5. To position an air sliding fifth wheel, set the trailer brakes, unlock the cab control air valve and allow the air cylinder to retract the locking wedges. Ease the tractor forward or backward to move the fifth wheel to the desired position and lock the air valve.

Position a manual sliding fifth wheel, by pulling up and out on the pull handle. Drop it outside the handle guide. Ease the tractor forward or backward to position the fifth wheel. Pick up the pull handle and allow it to spring back into a locked position.

After the fifth wheel is properly positioned, inspect the locking wedges to ensure that they are fully engaged in the slide rail pockets.

**Under no circumstances should a sliding fifth wheel be re-positioned while the tractor and trailer are in motion.**

**Do not attempt to slide the fifth wheel until all persons are clear of the vehicle.**

### **UNCOUPLING PROCEDURE:**

1. Prior to uncoupling, set the trailer parking brakes. Back the tractor gently against the trailer. This will release the load on the fifth wheel locking mechanism.

**IF THE TRUCK HAS AN AIR SUSPENSION, DO NOT DUMP THE AIR BEFORE OPENING THE FIFTH WHEEL. DOING SO MAY CAUSE A HARD TO OPEN SITUATION.**

2. Block the trailer wheels. If poor ground conditions exist you may have to provide a base for the trailer landing gear.
3. Lower landing gear until it contacts the ground. Give extra turns to reduce load on fifth wheel.  
**DO NOT RAISE TRAILER OFF OF THE FIFTH WHEEL.**
4. Disconnect air lines and open the fifth wheel.
5. Slowly drive tractor from under trailer.

## Section IV – Inspection and Maintenance Procedures

Using a suitable solvent, degrease the fifth wheel and mounting brackets every 90 days or 30,000 miles, whichever comes first (fifth wheels used in applications with less than 30 miles between stops regardless of road and trailer type, number of axles towed, or gross combined vehicle weight (GVW) are subject to increased maintenance intervals.

Recommended inspection and maintenance procedures should be performed every 45 days or 15,000 miles, whichever comes first), and inspect for:

1. Cracks in the fifth wheel assembly, mounting brackets, and mounting parts.
2. Wear and/or damage to moving parts.
3. Free operation of the secondary lock spring (5000 & 5092 series only).
4. Loose nuts and bolts in the fifth wheel and in the mounting hardware.
5. Securely fastened and properly working springs.
6. Check to see if both bracket pins are in place and secured by retainer pins and cotter pins.
7. Free front to rear rock on brackets with greaseless liners. If the fifth wheel does not rock freely, remove the top plate and inspect the bracket liners. Replace liners that are broken or have worn excessively. Check the bracket liner thickness at every scheduled maintenance. Replace liners if the thickness is less than .125" at the top of the liners.
8. Proper operation of the slide locking mechanism. Check for air leaks in the cylinder and supply line.
9. Wedge Stop Rod Setting: Close the fifth wheel on a standard 2" kingpin or a 2" diameter shaft inserted vertically. Push on the wedge stop rod.

# Inspection and Maintenance Procedures

(Extends from the side of the top plate and looks like the head of a bolt). It should move in 1/4" with hand pressure, then spring back. To obtain a proper setting, turn the wedge stop rod clockwise to reduce the dimension and counter-clockwise to increase it. Adjust until the free travel is 1/4" (See Figure 17, 18 & 19). This will allow the automatic slack adjustment feature of the Fontaine Fifth Wheel to function properly.

**FIGURE 17 – NO-SLACK® 6000/7000/7000CC**

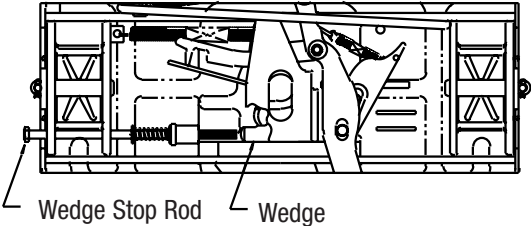

**FIGURE 18 – NO-SLACK® 5000/5092 SERIES**

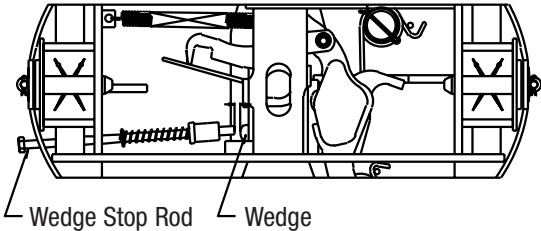

**FIGURE 19 – WEDGE STOP ROD SETTING**

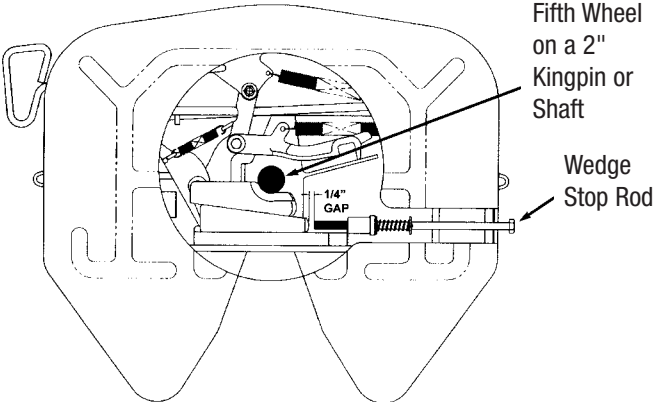

### Lubrication

Follow the instructions provided in the Pre-Service Procedure on pages 17-25.

Periodically remove the fifth wheel to clean old grease from the bracket grease channels to help insure an even grease distribution of fresh grease.

Special precautions should be taken during cold weather to ensure that the Fontaine No-Slack® locking mechanisms operate freely. Ice and sludge can build up and lubricants become thick and binding at low temperatures. When the temperature drops below freezing, Fontaine recommends a thorough cleaning of the latching mechanism using a suitable cleaner or degreaser to make sure that all moving parts operate freely. Lubricate the fifth wheel prior to opening and closing. Refer to Figure 20 on next page. Grease the jaw and wedge on top and bottom. Separate the jaw and wedge with a large screwdriver and distribute the grease along the full length of the jaw and wedge mating surfaces. Open and close the fifth wheel several times to further distribute the grease.

**Fontaine suggests the use of a Moly based lubricant such as Mobilgrease XHP320 or equivalent when applying lubricant. (Areas or regions that experience extreme and/or prolonged freezing temperatures should consider using a less viscous substance such as: 90-weight oil, diesel fuel, kerosene, motor oil, etc. Doing so will help ensure proper movement/ lubrication of the latching mechanism. Fontaine suggests contacting your specific lubricant manufacturer for guidelines on mixing compatibility of any lubricant.)**

The regular performance of the routine, "90-Day/ 30,000 Mile Preventative Maintenance Procedure," is also recommended.

# Inspection and Maintenance Procedures

FIGURE 20

Clean Oil/Grease All Moving Parts (arrows)

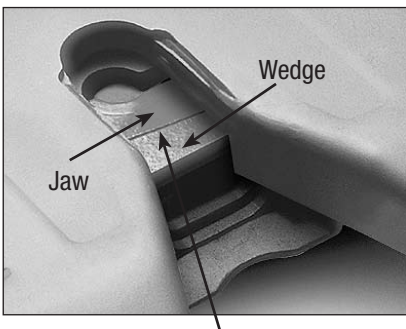
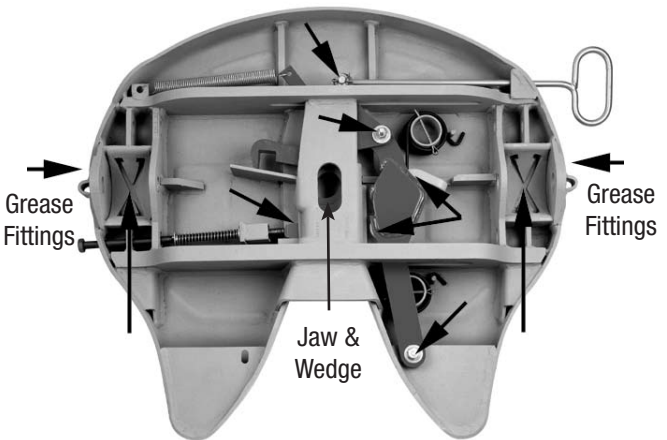
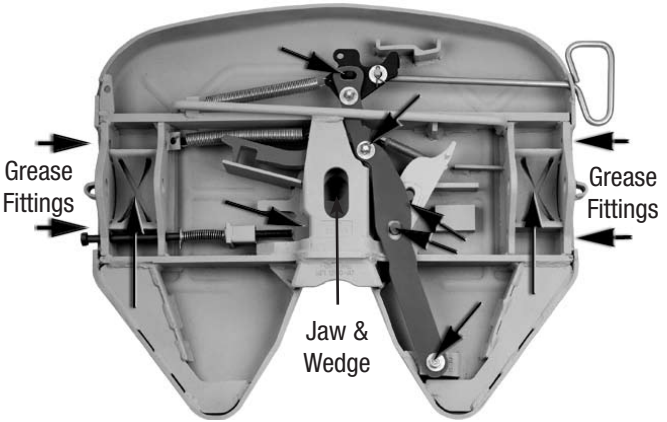

Separate Jaw and Wedge with screwdriver here – grease full length.

## **Section V – Fontaine Limited Warranty**

### **Basic Limited Warranty**

Fontaine Fifth Wheel Company (“Fontaine”) warrants each fifth wheel sold in North America on or after January 1, 2010 to be free from defects in material and workmanship for five years from the date of sale with the exception of Blocked and Xtra Heavy Duty fifth wheels which are warranted for two years.

This warranty does not cover failures due to:

1. Use in loads that are beyond federal and state highway limits or in special overweight load permits.
2. Improper installation of the fifth wheel (See appropriate Fontaine Instruction Handbook for proper installation procedures).
3. Normal wear.
4. Accident.
5. Improper application. See Fontaine Application Guide LT-076 for specific application recommendations. Product used in unapproved applications voids manufacture warranty.
6. Misuse, alteration or negligence.
7. Failure to properly maintain the fifth wheel (See appropriate Fontaine Instruction Handbook for proper installation procedures).
8. Inadequate repairs or alterations that, in Fontaine’s judgment, adversely affect the fifth wheel’s performance or reliability.

Fontaine cannot guarantee the service life of any fifth wheel since service life can vary with application, usage, maintenance, environment, and other factors beyond Fontaine’s control.

### **Limited Performance Warranty**

Fontaine warrants the performance of each fifth wheel sold in North America on or after January 1, 2010 that is used in a "standard duty application" for five years from the date of sale. A "standard duty application" requires that (i) the vehicle is used 100% on highways with more than 30 miles (48.3 kilometers) between each stop, (ii) the vehicle does not exceed a gross combined vehicle weight of 95,000 lbs. (43,000 kilograms), (iii) the total number of towed axles does not exceed two and (iv) the road type is maintained concrete or asphalt.

Fontaine warrants that each fifth wheel covered hereunder shall operate as described in the Fontaine Instruction Handbook, and the locking mechanism (jaw & wedge) will wear properly on the trailer kingpin when the fifth wheel is adjusted in accordance with the manufacture specifications. Fontaine fifth wheels are designed and manufactured for use with SAE 2" trailer kingpins that conform to SAE specification (SAE J700, February 1993) and are subject to the wear limits of SAE specification (SAE J2228, June 1993).

### **Lube Free Specific Warranty**

Fifth wheel lube free components are warranted for two years unlimited mileage per "standard duty application" requirements as listed.

### **Replacement of Parts and Repairs**

Authorization from Fontaine must be obtained before replacing or returning any part under this Limited Warranty. **All request for reimbursement must be submitted within 45 days of the repair.**

If the fifth wheel does not perform as warranted in this Limited Warranty, or if there is any defect in the material or workmanship covered by this Limited Warranty, Fontaine will, at its option, provide buyer with parts or reimburse the buyer for parts at its

## Fontaine® Fifth Wheel Handbook

---

reasonable acquisition cost, up to the amount of the original suggested retail price. Further, Fontaine will cover labor cost in repairing the fifth wheel as long as the labor rate is reasonable and the repair time does not exceed Fontaine's Standard Rate Time chart. Fontaine may require the unit or part to be returned to Fontaine's factory or a Fontaine authorized representative for evaluation. All freight to and from Fontaine or a Fontaine authorized representative must be prepaid.

**This is Fontaine's only warranty (Excludes Custom Duty fifth wheel warranty). Fontaine makes no other warranty of any kind, expressed or implied. All implied warranties or merchantability and/or fitness for a particular purpose are hereby disclaimed by Fontaine and excluded.** This Limited Warranty may not be changed except in writing by an authorized officer of Fontaine. Any action for any alleged breach of this Limited Warranty must be commenced within one year after such alleged breach occurred or shall be forever barred.

The remedies stated above shall be exclusive for any and all claims by the original user, or anybody claiming through the original user, against Fontaine, whether based on contract, negligence, tort, or any other theory. **In no event shall Fontaine be liable for any incidental or consequential damages, losses, or expenses.**

This limited warranty gives the buyer specific legal rights, and buyer may also have other rights, which may vary depending on the state, province or country where the truck is registered.

## **Service Locations / Audio & Video Tapes**

**For sales and service locations or for additional copies of this handbook go to our web site at [www.fifthwheel.com](http://www.fifthwheel.com).**

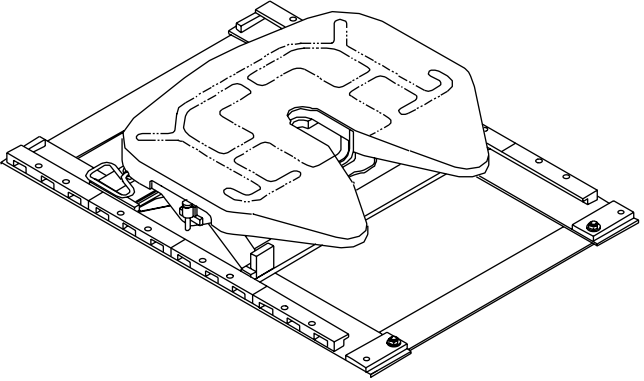

**Audio and Video tapes are available, free of charge, with instructions for fifth wheel maintenance, driver use of the fifth wheel and driver coupling/uncoupling instructions. Please contact Customer Services at 1-800-874-9780 to order these tapes.**



Fontaine Fifth Wheel  
7574 Commerce Circle • Trussville, AL 35173 USA  
800.874.9780 • Fax 205.655.9982  
[www.fifthwheel.com](http://www.fifthwheel.com)